

## EVACUATION

Please exit to the nearest stairway. There are two stairways at either end of the building "core area". Stair "A" is just past the restrooms to the right. Stair "B" is just past the freight elevator alcove to the right.

Stair "A" exits at main lobby, proceed out main lobby doors to the assembly area noted on **Evacuation Map** and report to your Fire Warden or Assistant.

Stair "B" exits at ground floor emergency exit corridor, proceed directly outside and turn right. Walk down drive to assembly area noted on **Evacuation Map** and report to your Fire Warden or Assistant.

Remember that you need to be as far away from the building as possible. Upon reaching your destination, please locate your Fire Warden to inform them that you have safely exited the building. The Fire Warden should be identifiable in a bright orange vest. It is important for a clear and accurate accounting of all individuals be communicated to fire and building management personnel. Once the Fire Warden has been informed that all is clear by Management or Fire Department, everyone may re-enter the building in a calm orderly manner.

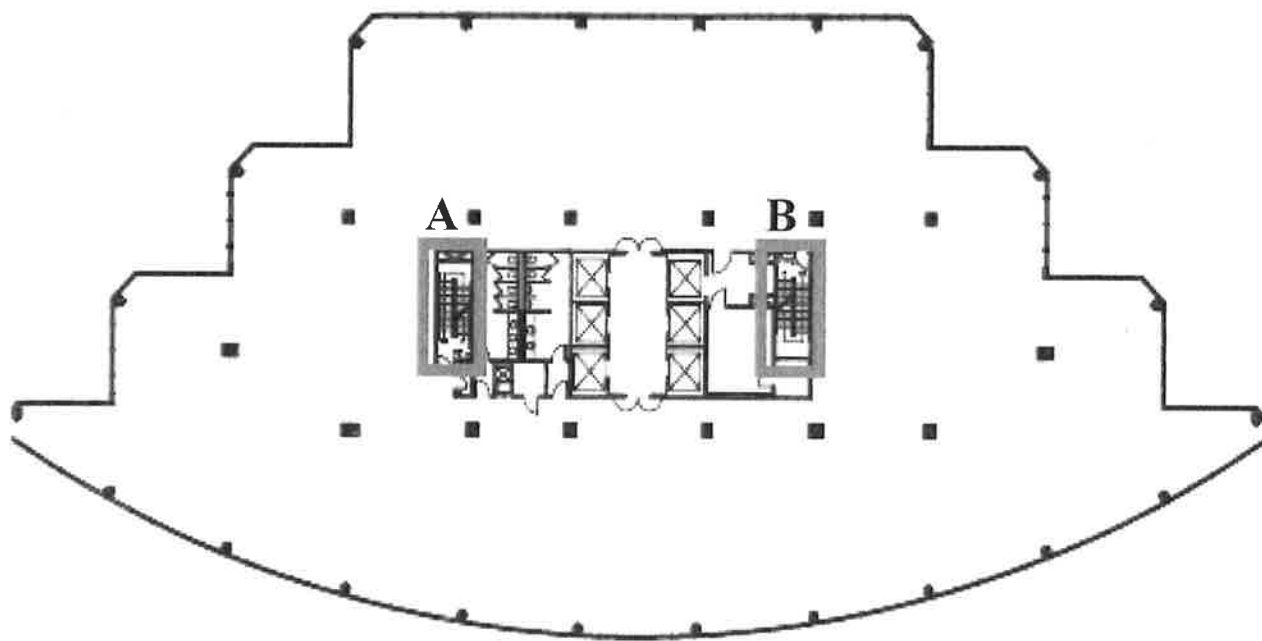

*Picture: Stairwell exits for a typical floor are highlighted in green. Please note that some floors' plans might not look exactly the same.*

## EVACUATION MAP

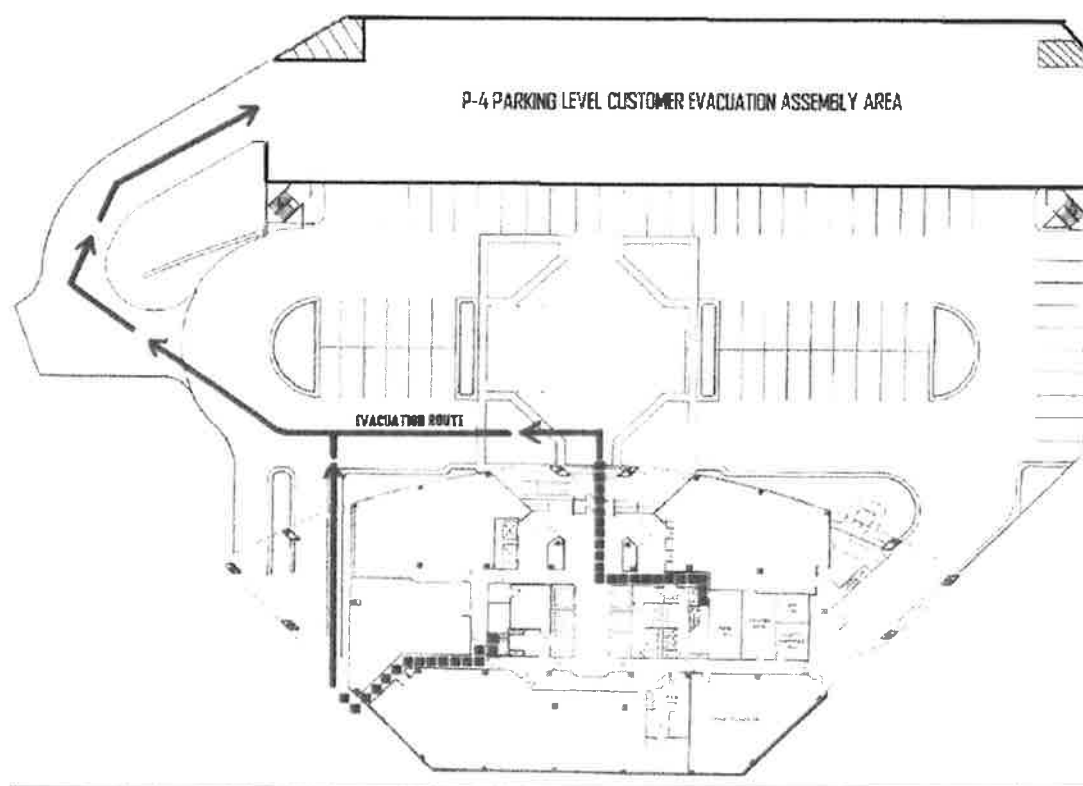

*Overlook II, 2839 Paces Ferry Road*

Phone: 770-431-6220